

CORTE AA
Escala 1/100

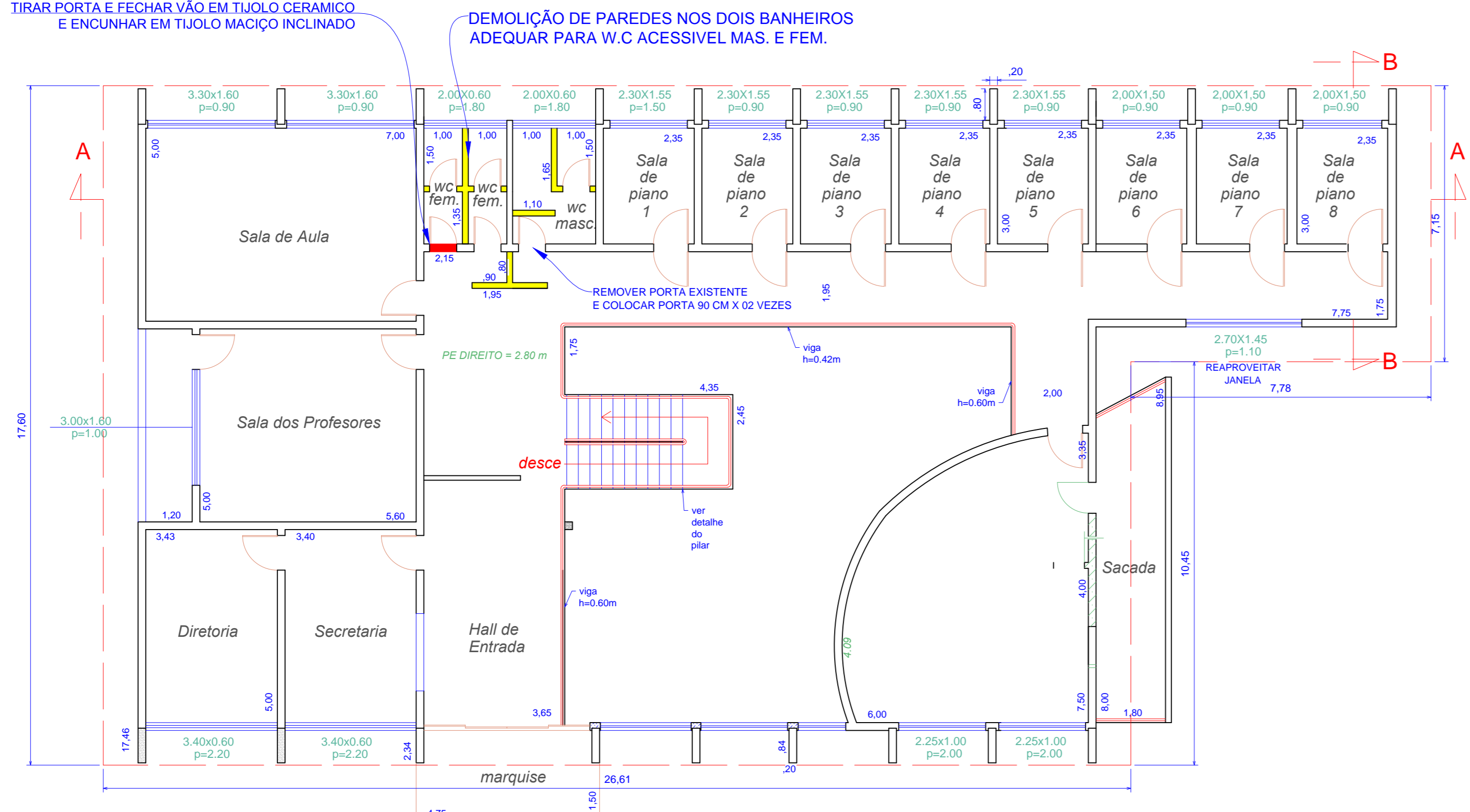

PLANTA BAIXA TERREO
Escala 1/100

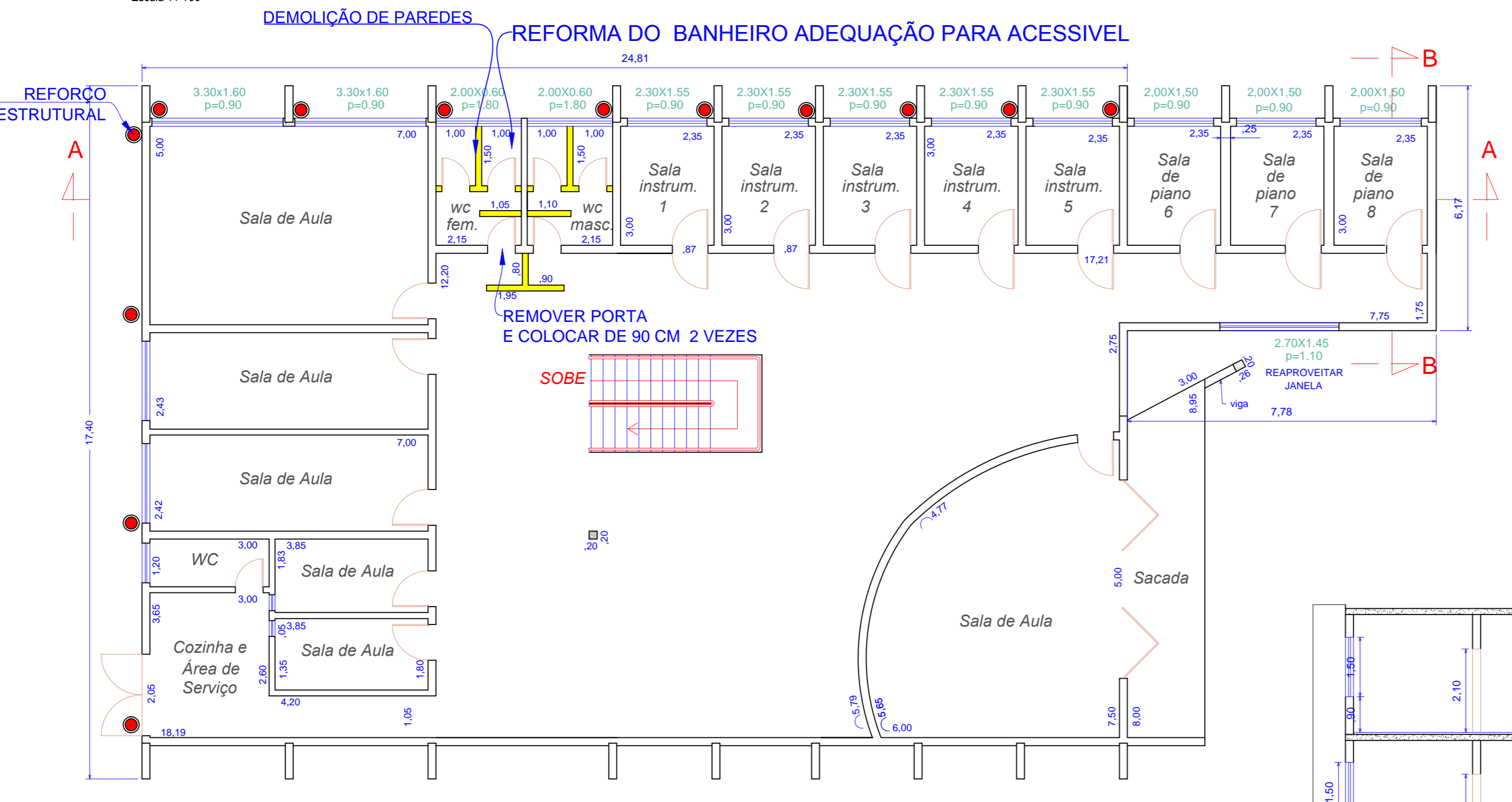

PLANTA BAIXA SUB SOLO
Escala 1/100

CORTE BB
Escala 1/100

W.C DO TERREO
REFORMA PARA ACESSIVEL

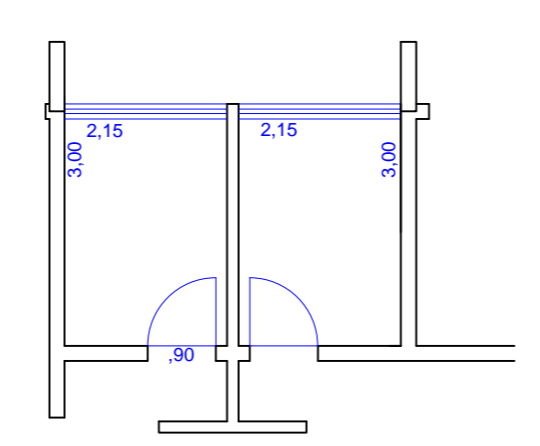

PLANTA BAIXA 1/100

WC DO SUB SOLO REFORMA E ADEQUAÇÃO
PARA ACESSIVEL

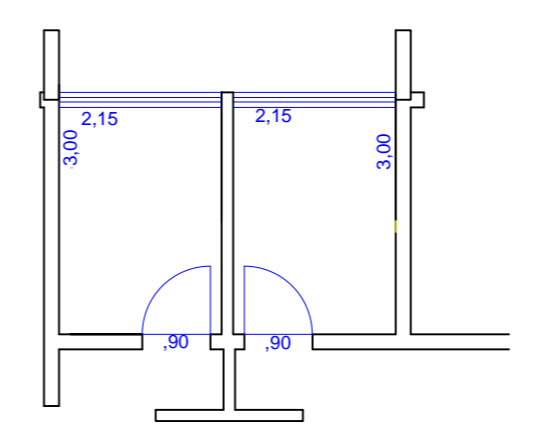

PLANTA BAIXA 1/100

LEGENDA

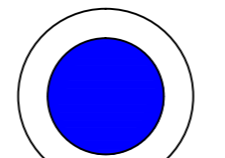
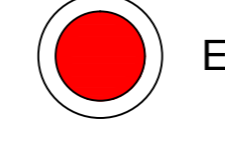
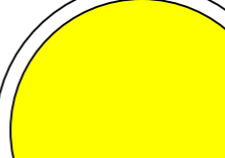
-  ALVENARIA DE TIJOLO CERAMICO 08 FURO 1/2 VEZ
-  REFORÇO NA FUNDAÇÃO EM ESTACA PREMOLDADA Ø 30 CM PROF 10,00 METROS CARGA 30 TONELADA 13 VEZES = 130 METROS
-  DEMOLIÇÃO

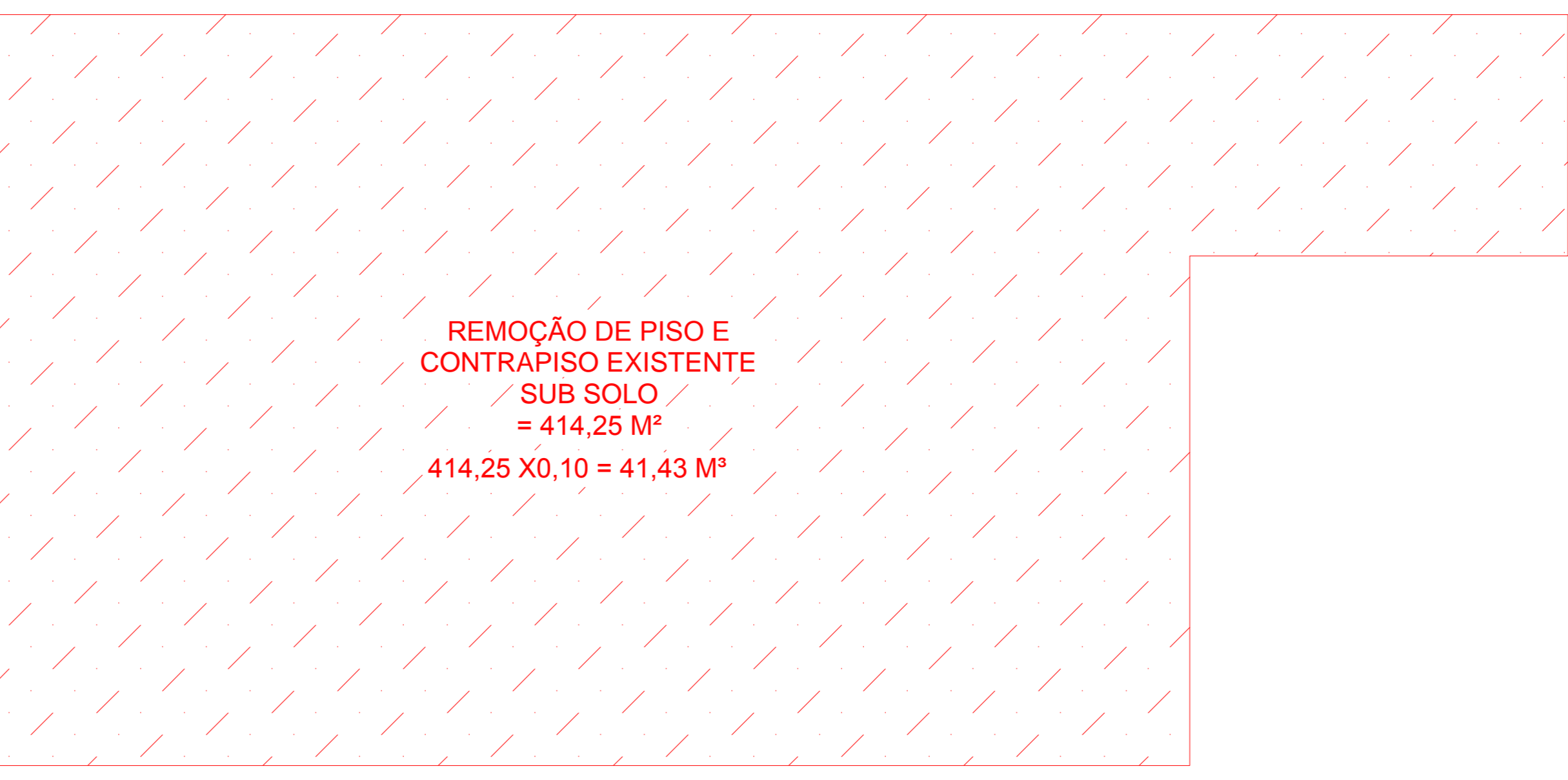

PREFEITURA MUNICIPAL DE MONTE ALTO - SP
SECRETARIA MUNICIPAL DE INDÚSTRIA, COMÉRCIO, TURISMO E MARKETING

OBRA: REFORÇO ESTRUTURAL E ADEQUAÇÃO DOS BANHEIROS (ACESSIVEL) E TROCA DE PISO E CONTRAPISO DO SUB SOLO DO CENTRO CÍVICO E CULTURAL "DOUTOR ELIAS BAHDUR"

ENDEREÇO: CENTRO CÍVICO E CULTURAL "DOUTOR ELIAS BAHDUR" RUA QUINZE DE MAIO, Nº 740-840 - CENTRO - MONTE ALTO S.P

CONSERVATÓRIO MUSICAL MUNICIPAL "MAESTRO MARIO VENERI"

MARIA HELENA AGUIAR RETTONDINI
Prefeita Municipal de Monte Alto

JAIR DURAN
ENG CIVIL CREA 0601409640